

BI-METAL THERMOMETER

MODEL B-99

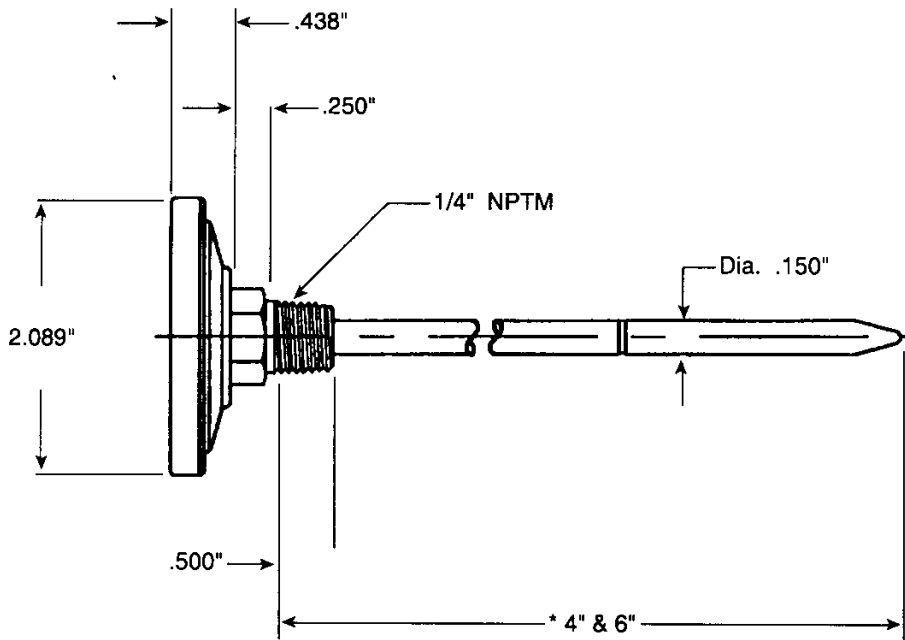

Materials:

Type 304 Stainless Steel
 All Welded Construction
 Polycarbonate Cover

Features:

Accurate to within 1% of total scale range
 Super sensitive helix bimetallic coil
 Dust and leak proof
 Hermetically sealed

Dual temperature range:

50-300 deg. F
 10-150 deg. C

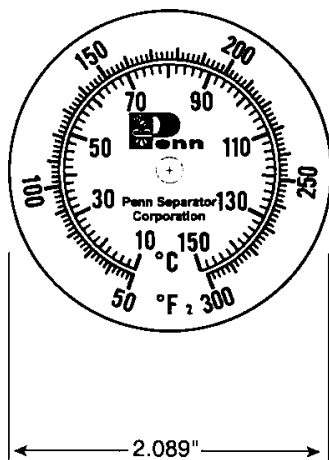

* Note:

4" units used on aftercoolers 3" and smaller

SALES OFFICE
PENN SEPARATOR CORP. BROOKVILLE, PENNSYLVANIA 15825
Bi-Metal Thermometer
Rev. 2 SAM 607
A 25032-1